

Direction of cable entry can be changed (left or right seen from NDE) and should be conformed by order

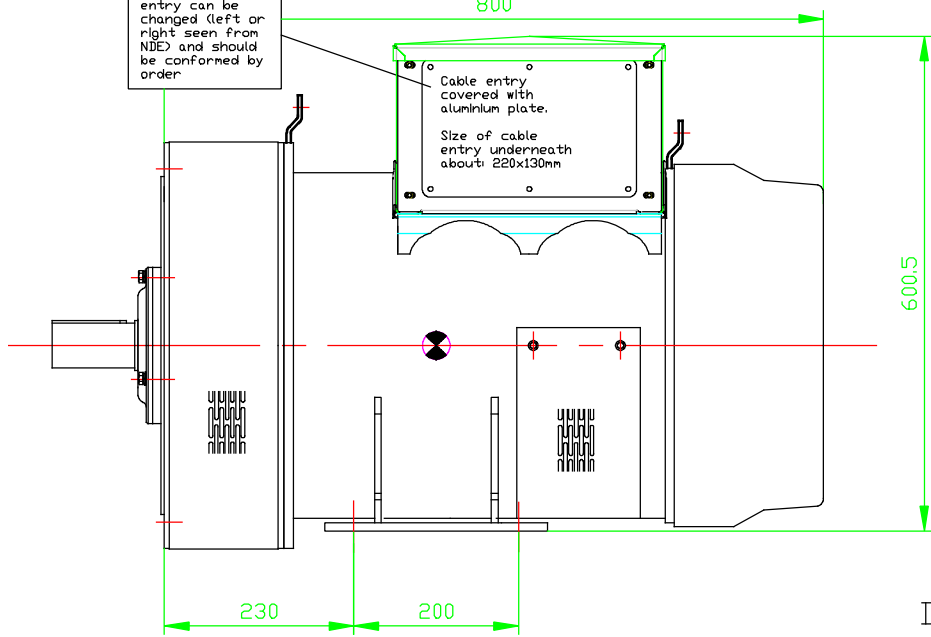

Access to AVR through coverplate on right side of terminal box (seen from NDE) SEE DETAIL

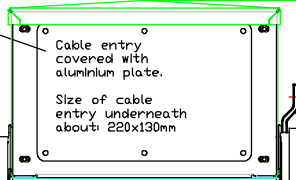
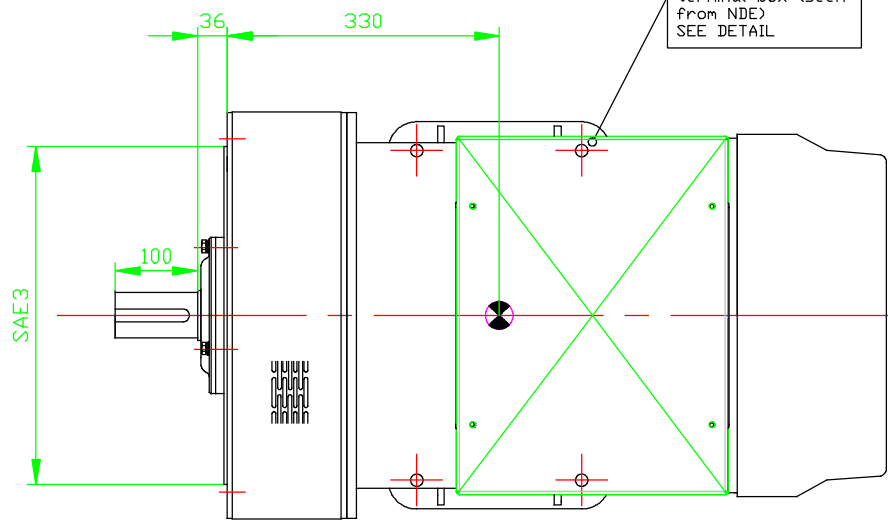

DETAIL

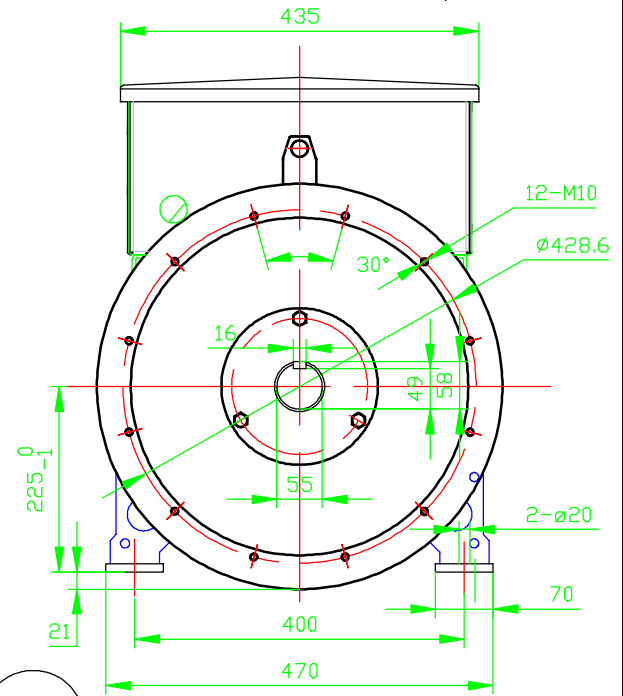
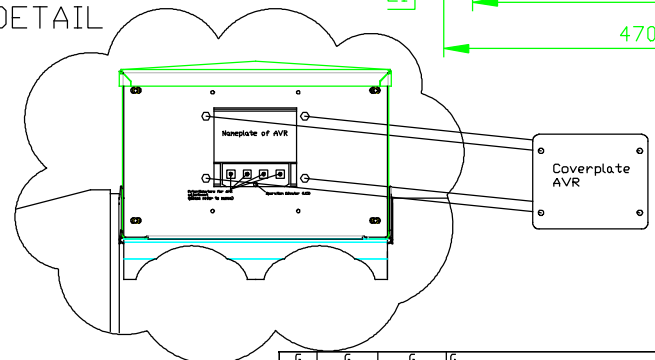

G	G	G	G	C A D
F	F	F	F	
E	E	E	E	
D	D	D	D	
C	C	C	C	
B	12.06.2012	Brunner F.	Input of height measurement on shaft Key, revision of terminal box	
A	12.06.2008	Brunner F.	First Issuance	
INDEX	DATE	NAME	REVISION	
<p>This document contains confidential information which must not be copied, nor disclosed to any person without our prior authority in writing</p>				<p>Type: ACG080-4-400 Drawing-number: ACG080D225 Revision: B</p>
Draw.	12.06.08	Brunner Florian	Frame size:	225
Coord.	12.06.08	Brunner Florian	Bearings:	doublebearing
Checked	12.06.08	Brunner Florian		
	Date	Name		
				<p>ACG Ges.m.b.H Badhöring 35 4782 St. Florian am Inn Austria</p>